

Courses Down
the Branch.

- N 57 E 102
- S 84 E 26
- S 45 E 38
- N 81 E 32
- N 14 E 32
- N 17 W 30
- N 37 W 26
- N 12 E 28
- N 75 E 24
- N 25 W 48
- N 41 E 40
426

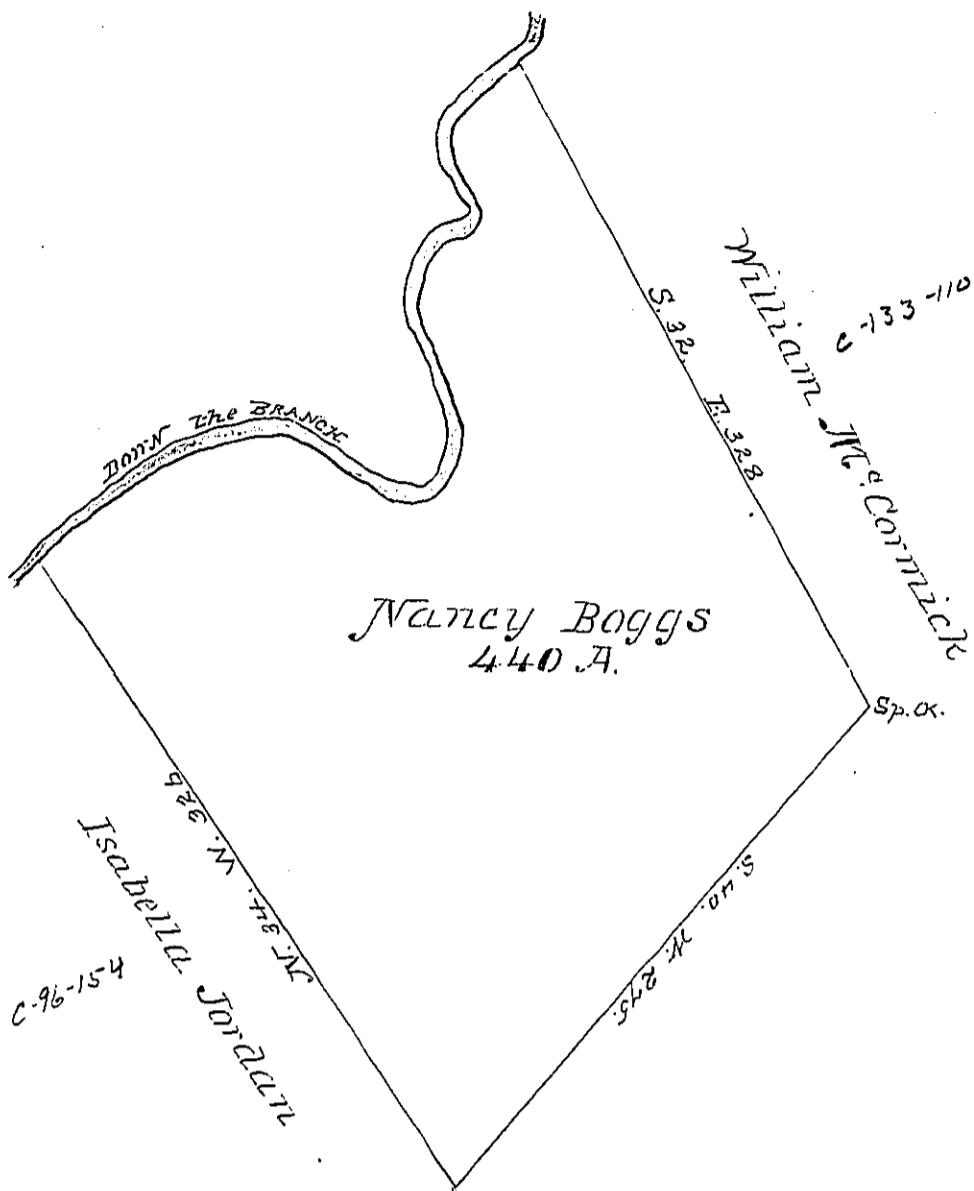

Draught of a Tract of Land, situate ^{the first northerly branch of} on the East Side of Clearfield Creek in the County of Bedford, containing, four hundred and forty Acres, and the usual Allowance of Six p^{cent} for Roads &c. Surveyed for Nancy Boggs June 5th 1785, in pursuance of a Warrant dated 8th day of July 1784.

George Woods, D.S.

John Lukens Esq: D.S.

IN TESTIMONY that the above is a copy of the original remaining on file in the Department of Internal Affairs of Pennsylvania, made conformably to an Act of Assembly approved the 16th day of February, 1833, I have hereunto set my Hand and caused the Seal of said Department to be affixed at Harrisburg, this

Twenty-eighth day of October 1890.

Thos. Stewart
Secretary of Internal Affairs